

Power VI Inversion Table

ITEMS FOR ASSEMBLY

Bed Frame Assembly	P1-2001
Chain with Manual Crank	P1-5004
Main Shaft Assembly	P1-2000
Two (2) Locking Knobs	P1-1003
Frame Base	P1-2002
Six (6) flat washers (12mm)	H1-1601
Six (6) threaded bolts (12mm)	H1-1600
Two (2) Handles	P1-2003
T-Pin (USA & Canada)	F5-1115
Loop (Heart) Pin	F5-1110

ITEM #'s

STL INSTRUCTIONAL MATERIALS

Instructional Training Manual	LP-1026
Training Poster	Z1-0017
Warranty Card	LP-1002
Brochure	LP-1020

IIL INSTRUCTIONAL MATERIALS

English	II-L600
French	II-L601
German	II-L602
Italian	II-L603

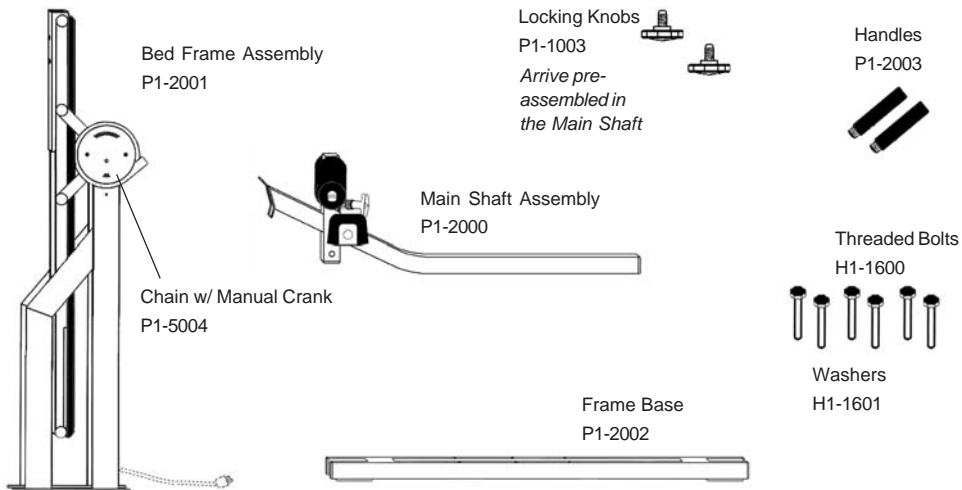

Required tools: 19mm wrench (3/4") and/or adjustable wrenches
** some hardware may arrive pre-assembled to the corresponding parts*