

Siesta 7FS Flash Streamer

by DAIKIN

Maintenance
made easy



1 When this light flashes it is time to change the filter sheet and clean the unit.



2 Switch off and unplug the unit.

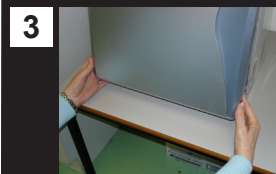

3 Remove the front panel - pull from either side at the bottom and lift.

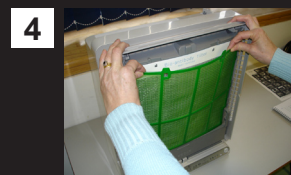

4 Un-clip and remove the green pre-filter.

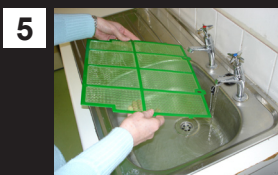

5 It can be rinsed under a tap to wash dust away. It is recommended to do this every 4 - 6 weeks.



6 Ensure pre-filter is totally dry before putting back in place.

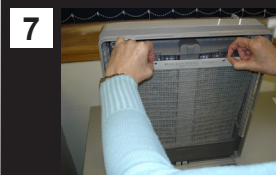

7 Remove bio-antibody filter. (Check date for renewal - should be changed every 12 months.)

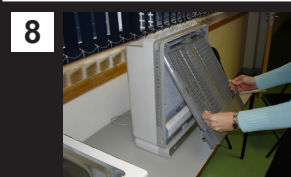

8 Remove ioniser cradle.

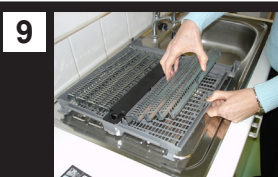

9 Press tab and lift ioniser plate (same both sides). Be careful to avoid damaging ioniser wires.

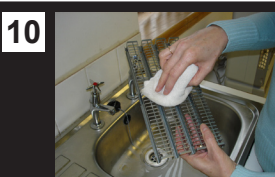

10 Wipe down ioniser plates (2) with a damp cloth and dry thoroughly.

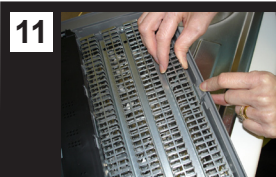

11 To replace, hinge inner edge of ioniser plate under lip, press plate down until it clicks under tab.



12 To clean "Flash Streamer" element, lift using hole at top of black strip.



13 Rinse under tap.

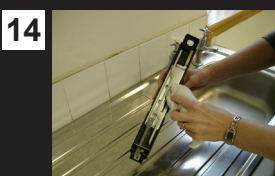

14 Carefully wipe clean with a cloth.



15 Ensure "Flash Streamer" element is totally clean and dry.

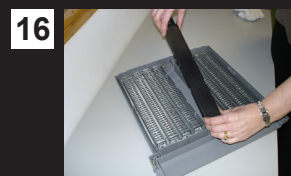

16 Replace "Flash Streamer" element into ioniser cradle.



17 Remove pleated filter sheet from the 5 locating lugs (3 top, 2 bottom). Throw old filter in the bin.



18 Replacement filters are stored in the base of the unit.

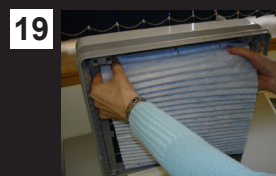

19 Place new pleated filter sheet onto the 5 locating lugs with the white side facing you.

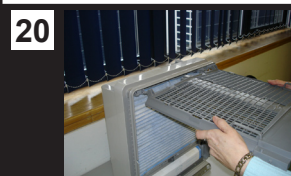

20 Replace ioniser cradle in the unit, starting at the top.

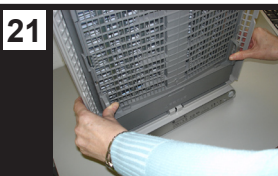

21 Push bottom into place using handles.



22 Replace bio-antibody filter using the 2 locating lugs.



23 Replace green pre-filter under 2 lips on either side of ioniser cradle.



24 Replace front panel. It is easier to start by locating the panel from the top.

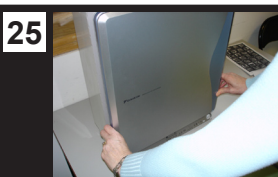

25 Press bottom in place ensuring a flush fitting all the way round the unit.



26 Plug in and switch on at the wall. Switch on unit using remote control.



27 The filter light will still flash. Re-set by pressing a pen into the hole to the right of flashing light. Unit will beep, light will go out.

IMPORTANT: These instructions are for advice only. Always refer to the instruction manual for detailed cleaning information.